

Hardware Documentation

aSt-ADP-EDT2

Version 1.00
(2016-04-15)



**Elektronik
Systeme**

© F&S Elektronik Systeme GmbH

Untere Waldplätze 23

D-70569 Stuttgart

Fon: +49(0)711-123722-0

Fax: +49(0)711 – 123722-99

About This Document

This document describes how to use the aStone EDT2 Display adapter with mechanical and electrical information. The latest version of this document can be found at:

<http://www.fs-net.de>.

History

| Date | V | Platform | A,M,R | Chapter | Description | Au |
|----------|-----|----------|-------|---------|--------------------|----|
| 15.04.16 | 1.0 | All | A | - | Build the document | MW |

V Version

A,M,R Added, Modified, Removed

Au Author

Table of Contents

| | |
|--|----|
| About This Document | 2 |
| History | 2 |
| Table of Contents | 3 |
| 1 Introduction | 4 |
| 2 Mechanical dimension | 5 |
| 2.1 Adapter | 6 |
| 3 Connector layout | 7 |
| 4 Connect the Adapter | 8 |
| 5 Interface and signal description | 9 |
| 5.1 J1 aStone-Connector | 9 |
| 5.2 J2 external Backlight Connecto | 10 |
| 5.3 J3 Display Connector for “G”-Pinout | 11 |
| 5.4 J4 Display Connector for standard Pinout | 13 |
| 6 Appendix | 15 |
| List of Figures | 15 |
| Important Notice | 16 |
| Warranty Terms | 17 |

1 Introduction

Display adapters make the connection between F&S-Boards and commonly used LCD – Displays as easy as possible. Usual in trade display connectors could be simply added to complete the connection.

With this Display adapter you can connect an EDT Display to an F&S-Board.

2 Mechanical dimension

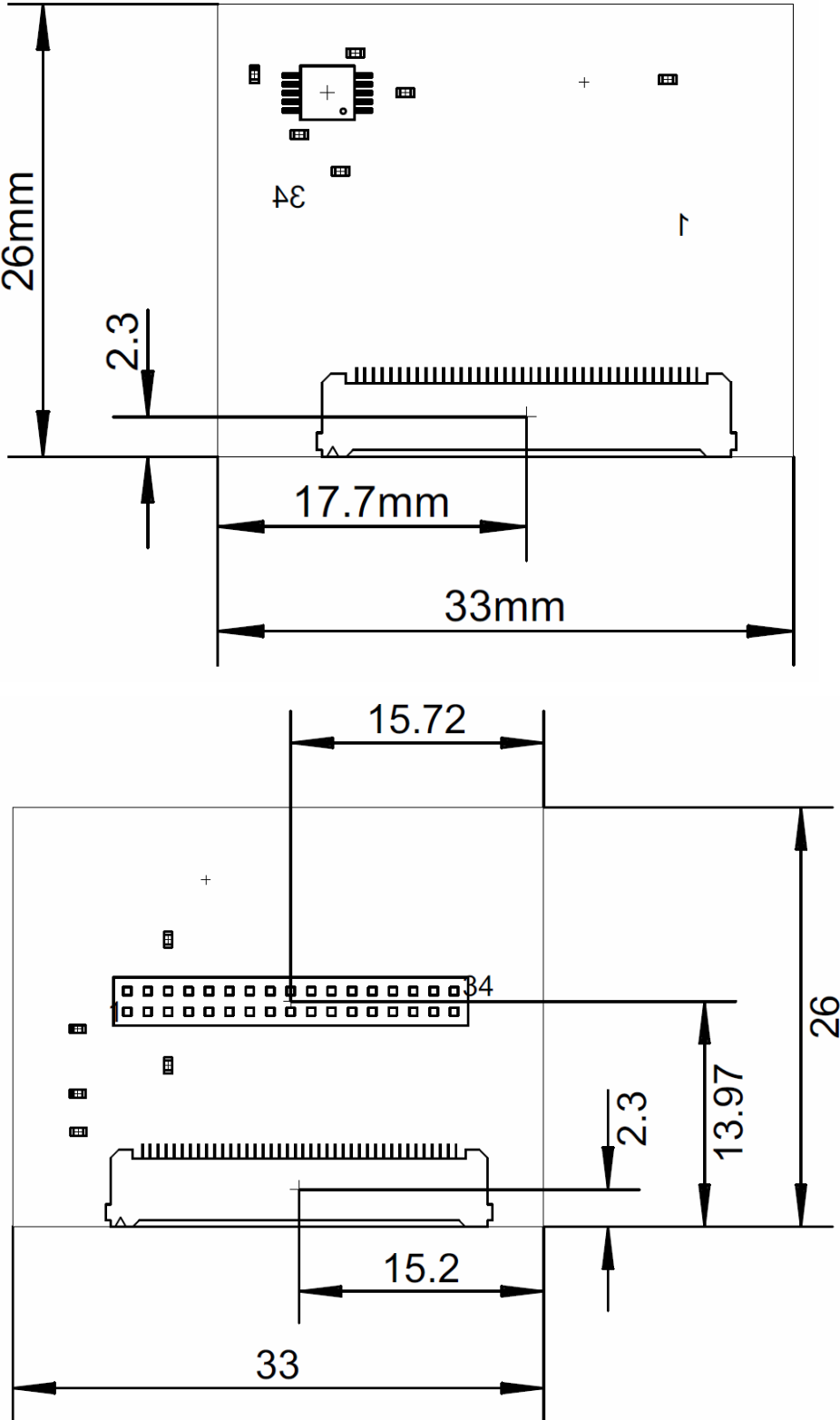

Figure 1: mechanical dimension

2.1 Adapter

| | |
|-----------------------------------|-------------|
| PCB size: | 26mm x 33mm |
| PCB thickness: | 1.6 ± 0.1mm |
| High of parts on the top side: | 4.7 mm |
| High of parts on the bottom side: | 5.4 mm |
| Weight: | 4 grams |

3 Connector layout

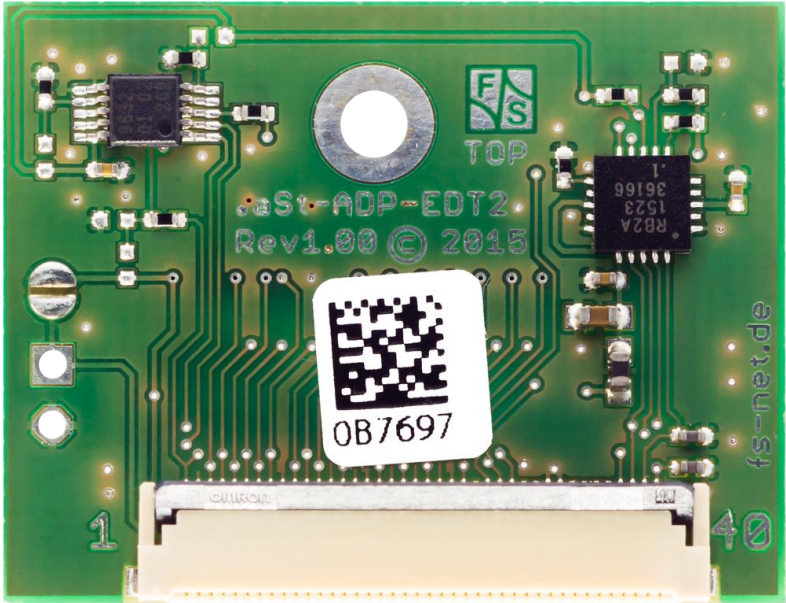

Figure 2: Connector Layout Top

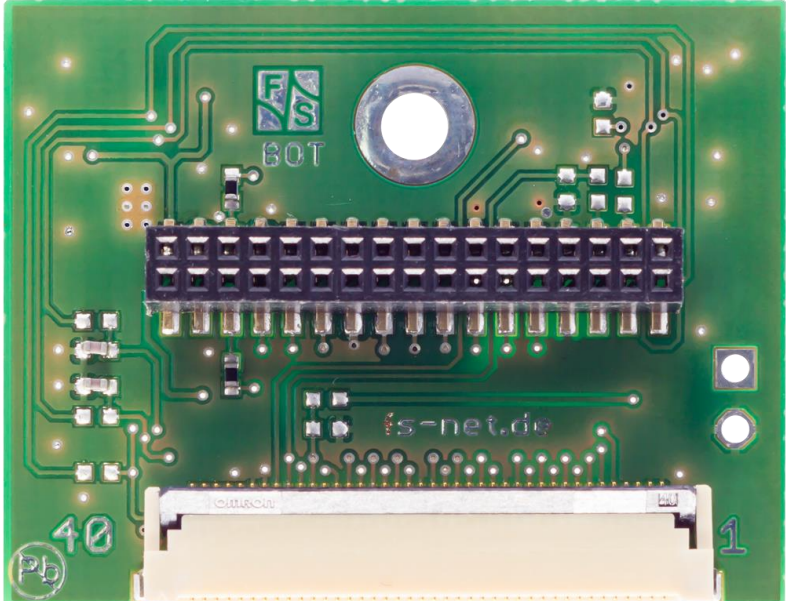

Figure 3: Connector Layout Bottom

4 Connect the Adapter



Figure 4: How the connect the Display

5 Interface and signal description

5.1 J1 aStone-Connector

| J1 | |
|-----|---------------|
| Pin | Function |
| 1 | 3,3 Volt |
| 2 | Not connected |
| 3 | Ground |
| 4 | LCD-CLK |
| 5 | LCD-HSYNC |
| 6 | LCD-VSYNC |
| 7 | Ground |
| 8 | LCD-R2 |
| 9 | LCD-R3 |
| 10 | LCD-R4 |
| 11 | LCD-R5 |
| 12 | LCD-R6 |
| 13 | LCD-R7 |
| 14 | Ground |
| 15 | LCD-G2 |
| 16 | LCD-G3 |
| 17 | LCD-G4 |
| 18 | LCD-G5 |
| 19 | LCD-G6 |
| 20 | LCD-G7 |
| 21 | Ground |
| 22 | LCD-B2 |
| 23 | LCD-B3 |
| 24 | LCD-B4 |

| J1 | |
|-----|----------|
| Pin | Function |
| 25 | LCD-B5 |
| 26 | LCD-B6 |
| 27 | LCD-B7 |
| 28 | Ground |
| 29 | LCD-DE |
| 30 | VLCD |
| 31 | VLCD |
| 32 | I2C-Data |
| 33 | I2C-IRQ |
| 34 | I2C-CLK |

5.2 J2 external Backlight Connecto

| J2 | |
|-----|------------|
| Pin | Function |
| 1 | VBacklight |
| 2 | Ground |

5.3 J3 Display Connector for “G”-Pinout

| J3 (mounted on the Top-Side) | |
|------------------------------|----------|
| Pin | Function |
| 1 | LCD-DEN |
| 2 | Ground |
| 3 | LCD-B7 |
| 4 | LCD-B6 |
| 5 | LCD-B5 |
| 6 | LCD-B4 |
| 7 | LCD-B3 |
| 8 | LCD-B2 |
| 9 | Ground |
| 10 | LCD-G7 |
| 11 | LCD-G6 |
| 12 | LCD-G5 |
| 13 | LCD-G4 |
| 14 | LCD-G3 |
| 15 | LCD-G2 |
| 16 | Ground |
| 17 | LCD-R7 |
| 18 | LCD-R6 |
| 19 | LCD-R5 |
| 20 | LCD-R4 |
| 21 | LCD-R3 |
| 22 | LCD-R2 |
| 23 | Ground |
| 24 | LCD-CLK |
| 25 | Ground |

| J3 (mounted on the Top-Side) | |
|-------------------------------------|--|
| Pin | Function |
| 26 | LCD-HSYNC (only if R18* is mounted) |
| 27 | LCD-VSYNC (only if R17* is mounted) |
| 28 | LCD-DE (only if R19 is mounted) |
| 29 | Ground |
| 30 | VLCD |
| 31 | Ground |
| 32 | Ground |
| 33 | Display-Rotate |
| 34 | VBacklight |
| 35 | I2C-Interrupt for capacitive Touch |
| 36 | LED-Control |
| 37 | Touch-Y+ / I2C-Clock for capacitive Touch* |
| 38 | Touch-X+ |
| 39 | Touch-Y- / I2C-Data for capacitive Touch* |
| 40 | Touch-X- |

*Mounting Option

5.4 J4 Display Connector for standard Pinout

| J4 (mounted on the Bottom-Side) | |
|---------------------------------|---------------|
| Pin | Function |
| 1 | Ground |
| 2 | Ground |
| 3 | VBacklight |
| 4 | VBacklight |
| 5 | Power-Control |
| 6 | LED-Control |
| 7 | LCD-DEN |
| 8 | LCD-B7 |
| 9 | LCD-B6 |
| 10 | LCD-B5 |
| 11 | LCD-B4 |
| 12 | LCD-B3 |
| 13 | LCD-B2 |
| 14 | Ground |
| 15 | LCD-G7 |
| 16 | LCD-G6 |
| 17 | LCD-G5 |
| 18 | LCD-G4 |
| 19 | LCD-G3 |
| 20 | LCD-G2 |
| 21 | Ground |
| 22 | LCD-R7 |
| 23 | LCD-R6 |
| 24 | LCD-R5 |
| 25 | LCD-R4 |
| 26 | LCD-R3 |

| J4 (mounted on the Bottom-Side) | |
|--|-------------------------------------|
| Pin | Function |
| 27 | LCD-R2 |
| 28 | LCD-CLK |
| 29 | Ground |
| 30 | LCD-HSYNC (only if R18* is mounted) |
| 31 | LCD-VSYNC (only if R17* is mounted) |
| 32 | LCD-DE (only if R19 is mounted) |
| 33 | Display-Rotate |
| 34 | Ground |
| 35 | Ground |
| 36 | VLCD |
| 37 | Touch-Y+ |
| 38 | Touch-X+ |
| 39 | Touch-Y- |
| 40 | Touch-X- |

*Mounted per default

6 Appendix

List of Figures

- Figure 1: mechanical dimension 5
- Figure 2: Connector Layout Top 7
- Figure 3: Connector Layout Bottom 7
- Figure 4: How the connect the Display 8



Important Notice

The information in this publication has been carefully checked and is believed to be entirely accurate at the time of publication. F&S Elektronik Systeme assumes no responsibility, however, for possible errors or omissions, or for any consequences resulting from the use of the information contained in this documentation.

F&S Elektronik Systeme reserves the right to make changes in its products or product specifications or product documentation with the intent to improve function or design at any time and without notice and is not required to update this documentation to reflect such changes.

F&S Elektronik Systeme makes no warranty or guarantee regarding the suitability of its products for any particular purpose, nor does F&S Elektronik Systeme assume any liability arising out of the documentation or use of any product and specifically disclaims any and all liability, including without limitation any consequential or incidental damages.

Specific testing of all parameters of each device is not necessarily performed unless required by law or regulation.

Products are not designed, intended, or authorized for use as components in systems intended for applications intended to support or sustain life, or for any other application in which the failure of the product from F&S Elektronik Systeme could create a situation where personal injury or death may occur. Should the Buyer purchase or use a F&S Elektronik Systeme product for any such unintended or unauthorised application, the Buyer shall indemnify and hold F&S Elektronik Systeme and its officers, employees, subsidiaries, affiliates, and distributors harmless against all claims, costs, damages, expenses, and reasonable attorney fees arising out of, either directly or indirectly, any claim of personal injury or death that may be associated with such unintended or unauthorized use, even if such claim alleges that F&S Elektronik Systeme was negligent regarding the design or manufacture of said product.

Specifications are subject to change without notice.

Warranty Terms

Hardware Warranties

F&S guarantees hardware products against defects in workmanship and material for a period of two (2) years from the date of shipment. Your sole remedy and F&S's sole liability shall be for F&S, at its sole discretion, to either repair or replace the defective hardware product at no charge or to refund the purchase price. Shipment costs in both directions are the responsibility of the customer. This warranty is void if the hardware product has been altered or damaged by accident, misuse or abuse.

Software Warranties

Software is provided "AS IS". F&S makes no warranties, either express or implied, with regard to the software object code or software source code either or with respect to any third party materials or intellectual property obtained from third parties. F&S makes no warranty that the software is useable or fit for any particular purpose. This warranty replaces all other warranties written or unwritten. F&S expressly disclaims any such warranties. In no case shall F&S be liable for any consequential damages.

Disclaimer of Warranty

THIS WARRANTY IS MADE IN PLACE OF ANY OTHER WARRANTY, WHETHER EXPRESSED, OR IMPLIED, OF MERCHANTABILITY, FITNESS FOR A SPECIFIC PURPOSE, NON-INFRINGEMENT OR THEIR EQUIVALENTS UNDER THE LAWS OF ANY JURISDICTION, EXCEPT THE WARRANTY EXPRESSLY STATED HEREIN. THE REMEDIES SET FORTH HEREIN SHALL BE THE SOLE AND EXCLUSIVE REMEDIES OF ANY PURCHASER WITH RESPECT TO ANY DEFECTIVE PRODUCT.

Limitation on Liability

UNDER NO CIRCUMSTANCES SHALL F&S BE LIABLE FOR ANY LOSS, DAMAGE OR EXPENSE SUFFERED OR INCURRED WITH RESPECT TO ANY DEFECTIVE PRODUCT. IN NO EVENT SHALL F&S BE LIABLE FOR ANY INCIDENTAL OR CONSEQUENTIAL DAMAGES THAT YOU MAY SUFFER DIRECTLY OR INDIRECTLY FROM USE OF ANY PRODUCT. BY ORDERING THE PRODUCT, THE CUSTOMER APPROVES THAT THE F&S PRODUCT, HARDWARE AND SOFTWARE, WAS THOROUGHLY TESTED AND HAS MET THE CUSTOMER'S REQUIREMENTS AND SPECIFICATIONS

